

## Supplies

- Brother Stellaire Embroidery/Sewing Machine set up for embroidery and free motion quilting
- Ruler Foot for your Machine – check your machine for shank height and choose the correct foot for your machine(High, Medium, Low or Slant Shank) Contact customer service if you are unsure before ordering. The Stellaire uses a high shank foot.
- EmbroideLee Starter Sampler Embroidery Series (Part #WE-SSSERIES)
- Westalee Design by Sew Steady Starter Sampler Ruler Work Kit in **high shank or low shank** matched to your machine's shank height (sampler kit contains 7 Template Designs that coordinate with the embroidery designs) (Part# WF-RERULERWORKKIT-HS or Part# WF-RERULERWORKKIT-LS)
- Sew Steady Extension Table to fit your machine (have your machine brand and model number handy when ordering an extension table)
- Sew Steady Ruler Work Glider is highly recommended
- Westalee Design by Sew Steady Crosshair Ruler is highly recommended
- Free Motion gloves are highly recommended
- Quilt ready for Quilting – layer quilt with extra wide batting and backing extending beyond all edges for ease in embroidery hooping and free motion quilting
- Quilting Thread for Needle and Bobbin
- **Fabric that is shown in video:** Yosemite Quilt Co – [Click here](#) for fabric

### *What is Custom Quilting?*

Custom quilting is designed and placed to enhance the look of the quilt by highlighting different areas of the quilt. The designs are placed with regard to the piecing pattern or an appliqué design or to create a secondary design. Edge to edge quilting is repeated design

that flows over the quilt to create an all-over look. It has long been the “go to” economical way of finishing a quilt on a long arm quilting machine. Some top-of-the-line embroidery machines, such as the Luminaire and Solaris, have guided edge to edge quilting using built in features that calculate the size, order and placement of a design. Professional quilters charge more for custom quilting because of the extra time involved for planning and placement.

Expert and novice quilters achieve professional looking results with both embroidery quilting and ruler work quilting. Embroidery quilting has the advantage of precise designs that are perfectly stitched. The limits of this type of quilting are hoop size and skillfully joining designs. Free motion ruler work quilting has the advantage of precision stitching designs, simple direct placement and ability to go anywhere on the quilt in any direction. The limits of this type of quilting are stitch length control, rigid template size and practice executing complex designs. Fortunately, a combination of both types of quilting will balance the advantages and limitations of both. Use embroidery quilting for the complex designs and the ability to change the size of the design. Use ruler work free motion quilting to join designs and create a cohesive whole design. The overall design of the quilt will look seamless when the embroideries and the rulers used are of the same shape and design such as the Embroidee Starter Sampler Embroidery Series and Westalee Design by Sew Steady Starter Sampler Rulers. Both the embroidery shapes and the ruler shapes are the same. (Brilliant!)

### *What is Possible with Embroidery Quilting?*

An embroidery quilting design is simply perfect. Even complex designs that may take years to master by free-hand free motion quilting execute perfectly with embroidery. Quilting with embroidery is now easier than ever with new designs, larger hoop sizes and enhanced placement features. Finishing a quilt with edge-to-edge embroidery quilting has been simplified with the larger hoops available and special features on the top machines. Custom embroidery quilting is possible with multiple hoopings on any embroidery machine. The look of seamless quilting can still be challenging even with the largest hoops available and with the advantage of advanced placement features. For example, fitting a design into a 12” square block is only possible by splitting and then perfectly joining the parts of the design. Embroiderers with more limited hoop size on mid-range embroidery machines generally do

not have an advantage to custom finish a quilt with embroidery quilting. If they want a professional looking quilt the two choices are to send it out to a professional or be really good at free motion quilting. Is there a good solution? Yes. Now for owners of all sizes of embroidery machines can create custom, professional looking quilting with a hybrid approach of both embroidery quilting and matching ruler work. Create a custom quilting design by placing embroidery quilting designs when possible and joining or expanding them with ruler work designs.

### *What is Possible with Free Motion Ruler Work Quilting?*

Ruler work free motion quilting has the advantage of providing a guide for perfect designs while quilting in any direction on the quilt. The machine is set up for ruler work free motion stitching by dropping the feed dogs and attaching a ruler work foot. Provide a wide surface for moving the quilt by using an extension table or lowering the machine flush with the surface of a cabinet. Make the surface slick with a glider sheet and use free motion gloves to help move the quilt. Gripper tape is very helpful on the bottom of the ruler to further grip the surface. Keep the quilt from dropping off the edge of the table by arranging the quilt around the machine.

The ruler work foot has a thicker profile than the standard free motion feet and is an optional foot for most machines. It is specific for the shank type of the machine. Machines will fall in one of four types of shank height: high, medium, low and slant. When installed on the machine, the needle will sit in the middle of the foot and  $\frac{1}{4}$ " away from all edges of the round foot. Install the foot on the machine by removing the ankle of the foot and placing the ruler work foot loosely on the attachment screw. The foot will have a slot for attachment to allow for height adjustment depending on the thickness of the quilt. Place the quilt under the foot and position the foot just grazing the surface (about  $\frac{1}{16}$ " or 1-2 mm). Tighten the foot in position. Be aware of any thicker areas of the quilt such as where multiple seams come together. Make sure to lower the presser foot lever and place the machine in free motion mode before adjusting the foot.

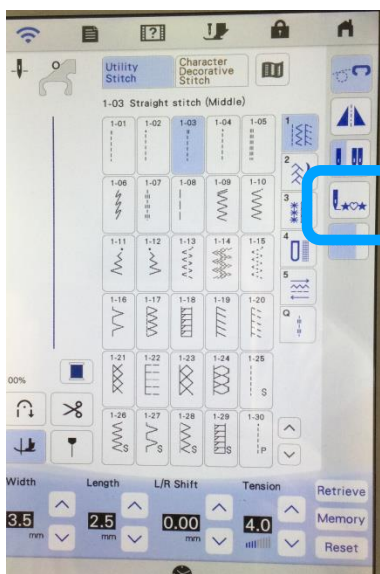

The Brother Stellaire and similar machines have a free motion height adjustment in the settings to raise and lower the height of the foot for thicker areas. After installing the foot, select the straight stitch and make sure the needle is in the center of the foot. Adjust the needle position if necessary.

Because the needle is  $\frac{1}{4}$ " from the edge of the ruler work foot, place the ruler  $\frac{1}{4}$ " from the desired location of the stitching. Place the needle at the start point and align the ruler next to the needle. Place the ruler  $\frac{1}{4}$ " from the desired ending point. A spacing gauge can be helpful in placing the endpoint and a crosshair ruler is ideal for marking angles for placement. When stitching lines longer than the template, use a washable marker to mark the waypoints for ruler placement. With practice, visually placing the ruler becomes easier. Move the quilt by pressing down on the template and pressing the template against the side of the ruler foot. Gripper strips on the bottom of the ruler are helpful in helping create a grip with the ruler. Keep one hand on the template and the other on the quilt. The template can be placed in any orientation to the ruler foot. Use free motion gloves to help move the quilt. Move the quilt by pushing with both the free hand and the hand pressing on the template. Keep the template in constant contact with the foot. The ruler foot is placed inside some templates to create many different closed designs such as circles and stars. For even stitches, move the quilt at a speed consistent with the speed of the machine. Free motion quilting takes some practice. Moving the quilt at a consistent correct speed is simpler if the machine is set to a maximum top speed. Use the speed control at the top of the Stellaire to limit the top speed of the machine. Try setting the slider to  $\frac{1}{2}$  way. To find the speed best for you, place a practice quilt sandwich under the standard presser foot with the feed dogs up. Set the stitch length for the length desired in the free motion quilting. Press the foot control all the way down and observe the speed that the quilt is moving under the needle. Adjust the slider to a speed that is good for you. When the top speed feels right, press the foot control all the way down and stitch with your hands resting lightly on the top of the quilt. As the machine pulls the quilt through, remember that speed. Raise the foot and try to duplicate that speed while moving the quilt with the feed dogs down. Remove the standard foot and practice moving the quilt under the needle without stitching. Install the ruler foot and practice moving the quilt with the template without stitching. Remember to keep the machine stitching at a consistent speed by either pressing the foot control all the way down or using the start/stop button.